

V9.1

BLASTHOME™

INSTALLATION INSTRUCTIONS

FOR:

Finials

Pair with Signature Collection Curtain Rod Sets

Note: Please save or responsibly recycle unused zinc metal end caps which were included with your rod sets.

PARTS INCLUDED:



x1

Allen wrench



x3

Small hex screw

Styles vary



x2

Finial

Tools needed: Ladder

NOTE: A hex screw can run away, so we've included one extra each!

1

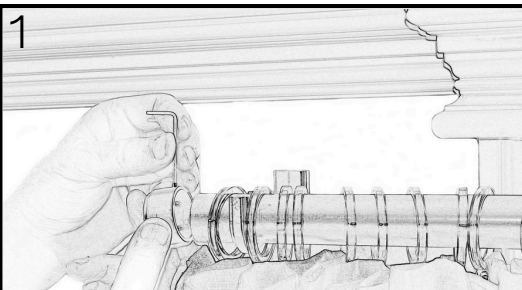

Begin by loosening small hex screw from end cap on curtain rod and remove.

2

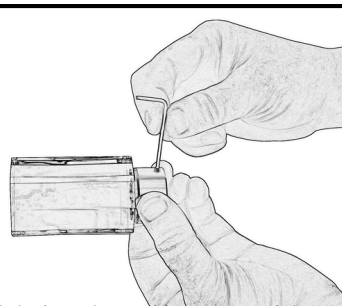

Use allen wrench to insert small hex screw into finial collar location.

3

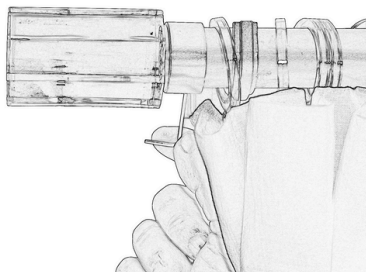

Hold finial on end of rod and use allen wrench to tighten small hex screw and secure finial on rod.

4



Repeat on other side and enjoy :)